

HD 10/25-4 S ST CLASSIC

Easy assembly, operation, maintenance and optimum cleaning results: the robust HD 10/25-4 S St Classic stationary cold water high-pressure cleaner.



Made in Germany



3-4 h



ANTI-TWIST



EASYLock



AUTO SHUTDOWN

Order no.

1.367-412.0

- Air/water-cooled, 4-pole low-speed motor
- Easy installation, operation and maintenance of the machine

Technical data

EAN code		4054278967431
Supply voltage	Ph / V / Hz	3 / 376 - 424 / 50
Flow rate	l/h	500 - 1000
Inlet temperature	°C	60
Working pressure	bar	60 - 250
Max. pressure	bar	310
Connected load	kW	8.8
Power cable	m	5
Nozzle size		045
Water inlet		1"
Weight (with accessories)	kg	59.3
Weight incl. packaging	kg	65
Dimensions (L × W × H)	mm	720 × 522 × 418

Users must receive training on this device.

Equipment

High-pressure hose	m	10
Spray lance	mm	840
Power nozzle		■
Crankshaft pump with ceramic pistons		■
4-pole, three-phase motor with air and water cooling		■
Pressure switch-off		■
Integrated water fine filter		■
High-pressure spray lance		■
Brass water inlet		■

■ Included in the scope of supply.

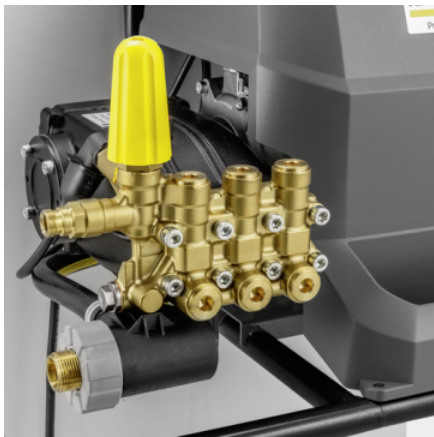

Powerful and robust crankshaft pump with brass cylinder head and pistons with ceramic sleeves

- High performance and high efficiency.
- Long service life and low maintenance costs.
- With suction feature and up to 60 °C water temperature.



Robust, stationary chassis

- A robust tubular steel frame reliably protects the machine against damage.
- Sturdy tubular steel frame protects all components.
- Integrated storage space for accessories.



Classic accessories with EASY!Lock connections

- Quick set-up and pack-up plus easy accessory replacement.
- Robust and durable accessories.
- Easy to use

ACCESSORIES FOR HD 10/25-4 S ST CLASSIC

1.367-412.0

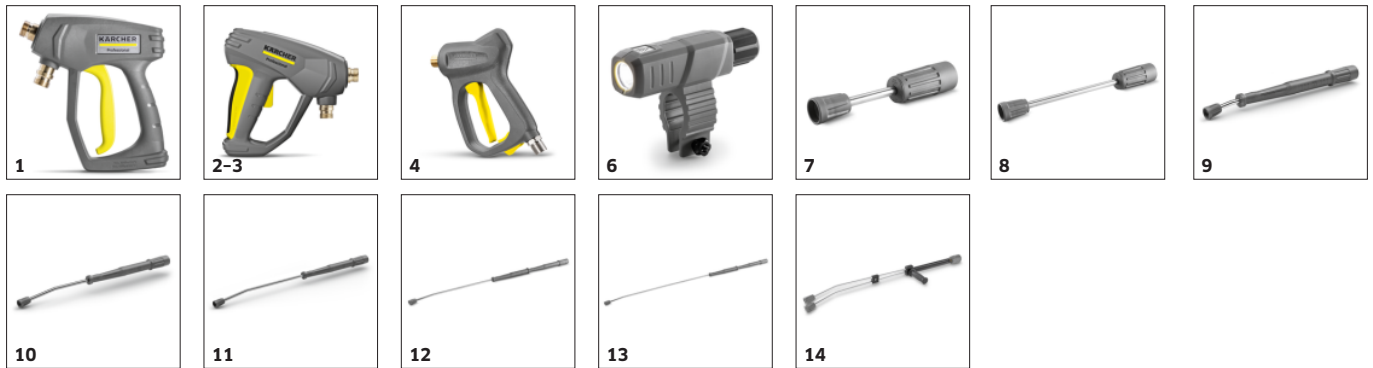

	Order no.	Description	
TRIGGER GUNS			
Spray guns			
Pistol TR 155°C with package	1 4.119-002.0	High-quality Classic spray gun with robust valve. Also suitable for Kärcher hot water high-pressure cleaners.	■
EASY!Force Advanced	2 4.118-005.0	Effortless, not energy-sapping: the EASY!Force high-pressure gun uses the recoil force of the high-pressure jet to reduce the holding force for the operator to zero.	□
EASY!Force Food	3 4.118-015.0	Perfect for the food industry: the EASY!Force high-pressure gun with full ceramic valve enables fatigueless working due to virtually zero holding force for the operator.	□
High-End HD Trigger Gun	4 4.118-011.0	Robust, durable high-end spray gun for use in the food industry and industry. Very low pressure loss - even with water volumes up to 2500 l/h.	□
SPRAY LANCES			
Rotating spray lances			
Jet pipe with transport packaging, 840 mm	5 4.119-003.0	Rotating Classic spray lance with ergonomic handle bowls in a robust and high-quality stainless steel design. Also suitable for Kärcher hot water high-pressure cleaners.	■
LED nozzle light	6 2.680-002.0	Bright, lightweight LED work light for direct mounting on spray lance of EASY!Force high-pressure gun. Better view in unfavourable lighting conditions for up to 5 working hours.	□
Spray lance, 250 mm, rotatable	7 4.112-027.0	Spray lance, 250 mm, rotatable, ergonomic	□
Spray lance, 400 mm, rotatable	8 4.112-024.0	Spray lance, 400 mm, rotatable, ergonomic	□
Spray lance, 600 mm, rotatable	9 4.112-007.0	600 mm stainless steel lance (manual coupling) with ergonomic handle for ease of use and protection. Rotatable 360° under pressure.	□
Spray lance, 840 mm, rotatable	10 4.112-006.0	850 mm stainless steel lance (manual coupling) with ergonomic handle for ease of use and protection. Rotatable 360° under pressure.	□
Spray lance, 1050 mm, rotatable	11 4.112-000.0	1050 mm stainless steel lance (manual coupling) with ergonomic handle for ease of use and protection. Rotatable 360° under pressure.	□
Spray lance, 1550 mm, rotatable	12 4.112-018.0	1550 mm stainless steel lance (manual coupling) with ergonomic handle for ease of use and protection. Rotatable 360° under pressure.	□
Spray lance, 2050 mm, rotatable	13 4.112-021.0	2050 mm stainless steel lance (manual coupling) with ergonomic handle for ease of use and protection. Rotatable 360° under pressure.	□
Double lance			
Double lance, 960 mm	14 2.112-016.0	960 mm double lance for variable pressure adjustment on handle at full water flow rate. Suitable for agricultural use (e.g. stable cleaning).	□

■ Included in the scope of supply. □ Available accessories.

ACCESSORIES FOR HD 10/25-4 S ST CLASSIC

1.367-412.0



		Order no.	Description	
SPRAY LANCES				
Flexible spray lance				
High pressure articulated joint	15	4.112-057.0	For hard-to-reach areas: High-pressure articulated joint with infinite angle adjustment up to 120°. Simply attach directly to the spray lance of the pressure washer.	<input type="checkbox"/>
Undercarriage spray lance				
Underbody lance	16	4.112-032.0	Stainless steel lance for effective and easy underbody and wheel arch cleaning. Without high-pressure nozzle.	<input type="checkbox"/>
Additional handle				
Additional handle for EASY!Lock spray lances	17	4.321-380.0	Comfortable in every situation – the additional handle is easy to attach to the spray lance of our new EASY!Lock generation and makes work easier by allowing you to adjust your posture to suit the particular task. Regularly changing your posture relieves the strain on your body, making work more relaxed. Thanks to the 360°-rotatable spray lance, the additional handle can simply be fully rotated whilst working for greater flexibility.	<input type="checkbox"/>
KÄRCHER POWER NOZZLE				
Power nozzle spray angle 25°				
Power nozzle 25°, 045	18	2.113-022.0	Fan jet nozzle with 25° spray angle, suitable for large areas and removing stubborn dirt and stains.	<input checked="" type="checkbox"/>
Power nozzle 25°, 052	19	2.113-024.0		<input type="checkbox"/>
Power nozzle . 055	20	2.113-025.0	Flat jet nozzle for large area performance and stubborn dirt.	<input type="checkbox"/>
HP nozzle spray angle 0°				
Power nozzle 0°, 045	21	2.113-033.0	High-pressure nozzle with powerful jet for extremely stubborn dirt.	<input type="checkbox"/>
Power nozzle 0°, 055	22	2.113-035.0		<input type="checkbox"/>
Power nozzle 0°, 060	23	2.113-036.0	Solid jet for very stubborn dirt and stains.	<input type="checkbox"/>
Power nozzle spray angle 15°				
Power nozzle 15°, 045	24	2.113-046.0	Fan jet nozzle with 15° spray angle suitable for stubborn dirt.	<input type="checkbox"/>
Power nozzle 15°, 055	25	2.113-047.0		<input type="checkbox"/>
Power nozzle spray angle 40°				
Power nozzle 40°, 045	26	2.113-053.0	Power nozzle with a 40° spray angle and fan jet, suitable for large areas and sensitive surfaces.	<input type="checkbox"/>
Power nozzle 40°, 050	27	2.113-054.0		<input type="checkbox"/>
NOZZLE UNION / SPACER				
Nozzle union				
Nozzle screws	28	4.112-011.0	Nozzle screws with protectors for high-pressure and power nozzles	<input checked="" type="checkbox"/>

■ Included in the scope of supply. □ Available accessories.

ACCESSORIES FOR HD 10/25-4 S ST CLASSIC

1.367-412.0

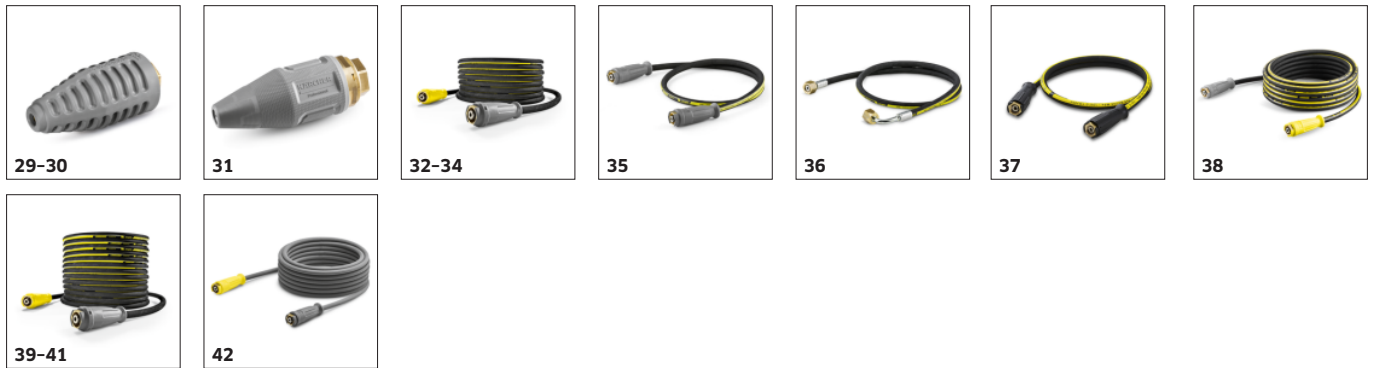

		Order no.	Description	
ROTARY NOZZLES (DIRT BLASTERS)				
Dirt blaster, large				
Dirt blaster, large, 050	29	4.114-027.0	The dirt blaster with rotating pencil jet offers 10 times better cleaning performance. Ceramic nozzle and bearing ring for a long service life. Further data: Max. 300 bar, 30 MPa, 85°C.	<input type="checkbox"/>
Dirt blaster, large, 055/060	30	4.114-036.0		<input type="checkbox"/>
Dirt blaster Vibrasoft, 050	31	4.114-066.0		Vibrasoft rotary nozzle with rotating point jet for ten times greater cleaning performance. Durable dirt blaster thanks to ceramic nozzle. Reduces vibrations by up to 30% for maximum ergonomics.
HIGH-PRESSURE HOSES				
Standard with unions on both sides				
High-pressure hose, 10 m, DN 8, 315 bar, 2 × EASY!Lock	32	6.110-031.0	High-pressure hose (DN 8) suitable up to 315 bar pressure. With innovative EASY!Lock manual screw fitting on both sides, ANTI!Twist and 10 m long.	<input type="checkbox"/>
High-pressure hose, 15 m, DN 8, 315 bar, 2 × EASY!Lock	33	6.110-030.0	15 m long high-pressure hose, DN 8, with ANTI!Twist and time-saving EASY!Lock manual screw fitting on both sides.	<input type="checkbox"/>
High-pressure hose, 20 m, DN 8, 315 bar, 2 × EASY!Lock	34	6.110-032.0	20 m long high-pressure hose (DN 8) equipped with the time-saving and robust EASY!Lock manual screw fitting on both sides. Approved for pressures up to 315 bar.	<input type="checkbox"/>
Longlife 400 with unions on both sides				
High-pressure hose Longlife, 1,5 m, DN 8, 400 bar, 2 × EASY!Lock	35	6.110-024.0	1.5 m short high-pressure hose (DN 8). Comfortable EASY!Lock manual screw fitting on both sides for robust and quick connections. Durable and designed for up to 400 bar pressure.	<input type="checkbox"/>
High-pressure hose Longlife, 1,5 m, DN 8, 400 bar, 1 × EASY!Lock / 1 × M22 × 1.5	36	6.110-069.0	1.5 m long high-pressure hose (DN 8) suitable for up to 400 bar pressure with double steel core. Connections: M 22 × 1.5, as well as the comfortable and quick EASY!Lock manual screw fitting.	<input type="checkbox"/>
High-pressure hose Longlife, 1,5 m, DN 8, 400 bar, 2 × M22 × 1.5	37	6.390-178.0	1.5 m high-pressure hose (DN 8, M 22 × 1.5) with kink protection and connectors at both ends. For connecting to hose reels with appropriate connector (M 22 × 1.5).	<input type="checkbox"/>
High-pressure hose Longlife, 10 m, DN 8, 400 bar, 2 × EASY!Lock	38	6.110-038.0	Durable, 10 m long high-pressure hose (DN 8) with double steel core and EASY!Lock manual screw fitting on both sides and ANTI!Twist. Approved for 400 bar pressure.	<input type="checkbox"/>
High-pressure hose Longlife, 30 m, DN 8, 400 bar, 2 × EASY!Lock	39	6.110-023.0	Robust high-pressure hose with double steel core, ANTI!Twist and EASY!Lock manual screw fitting on both sides. Nominal size DN 8, 30 m long, for up to 400 bar pressure.	<input type="checkbox"/>
High-pressure hose Longlife, 20 m, DN 8, 400 bar, 2 × EASY!Lock	40	6.110-027.0	High-pressure hose with ANTI!Twist, EASY!Lock manual screw fittings and double steel core. 20 m long, nominal size DN 8, EASY!Lock manual screw fitting on both sides.	<input type="checkbox"/>
High-pressure hose Longlife, 15 m, DN 8, 400 bar, 2 × EASY!Lock	41	6.110-029.0	The double steel core ensures a particularly long life of this 15 m long high-pressure hose (DN 8), which is approved for pressures up to 400 bar.	<input type="checkbox"/>
Food industry version with unions on both sides				
High-pressure hose food grade, 10 m, DN 8, 250 bar, 2 × EASY!Lock	42	6.110-051.0	High-pressure hose (ID 6), 10 m long, with grey, non-marking outer covering. Approved for use in the food industry. With quick and robust EASY!Lock hand screw connection at both ends.	<input type="checkbox"/>

■ Included in the scope of supply. □ Available accessories.

ACCESSORIES FOR HD 10/25-4 S ST CLASSIC

1.367-412.0



		Order no.	Description	
HIGH-PRESSURE HOSES				
Food industry version with unions on both sides				
High-pressure hose food grade, 20 m, DN 8, 250 bar, 2 × EASY!Lock	43	6.110-052.0	Suitable for use in food industry: 20 m long high-pressure hose (ID 8) with grey, non-marking outer covering, ANTI!Twist and EASY!Lock hand screw connections.	<input type="checkbox"/>
Longlife food design with screw connections at both ends				
High-pressure hose food grade Longlife, 10 m, DN 8, 400 bar, 2 × EASY!Lock	44	6.110-053.0	With blue, non-marking and animal fat resistant outer covering: durable high-pressure hose (ID 8), 10 m long, ANTI!Twist and EASY!Lock hand screw connection at both ends.	<input type="checkbox"/>
High-pressure hose food grade Longlife, 20 m, DN 8, 400 bar, 2 × EASY!Lock	45	6.110-054.0	Durable high-pressure hose with double steel reinforcement and blue, non-marking and animal fat resistant outer covering. 20 m long with EASY!Lock hand screw connections.	<input type="checkbox"/>
Special hoses				
High-pressure hose curved, 1.5 m, DN 8, 400 bar, 1 × EASY!Lock / 1 × M22 × 1.5	46	6.110-068.0	For connection to hose reels: high-pressure hose, with M 22 × 1.5 connection and curved EASY!Lock hand screw connection. 1.5 m long, suitable for up to 400 bar working pressure.	<input type="checkbox"/>
PIPE CLEANING				
Pipe cleaning hose, ID 6				
Pipe cleaning hose, ID 6, 10 m, max. 250 bar	47	6.110-046.0	The 10 m pipe cleaning hose is a highly flexible high pressure hose for pipe interior cleaning (threaded connection for nozzle R 1/8).	<input type="checkbox"/>
Pipe cleaning hose, ID 6, 20 m, max. 250 bar	48	6.110-008.0	The 20 m pipe cleaning hose is a highly flexible high pressure hose for pipe interior cleaning (threaded connection for nozzle R 1/8).	<input type="checkbox"/>
Pipe cleaning hose, ID 6, 30 m, max. 250 bar	49	6.110-047.0	The 30 m pipe cleaning hose is a highly flexible high pressure hose for pipe interior cleaning (threaded connection for nozzle R 1/8).	<input type="checkbox"/>
Pipe cleaning nozzle				
Pipe cleaning dirt blaster D21/060	50	4.765-002.0	The forward-tilted rotating pencil jet removes the most stubborn dirt. The three backwards-tilted jets ensure the necessary forward movement, as well as convenient handling.	<input type="checkbox"/>
Pipe cleaning dirt blaster D30/060	51	4.765-005.0		<input type="checkbox"/>
Pipe cleaning nozzle 080	52	5.763-087.0	Pipe cleaning nozzle with 24 mm diameter. With 4 nozzles tilted back at a 30° angle.	<input type="checkbox"/>
Pipe cleaning nozzle	53	5.763-019.0	16 mm pipe cleaning nozzle with internal thread. Various jet directions for environmentally-friendly cleaning of blocked drains and pipes.	<input type="checkbox"/>
	54	5.763-016.0		<input type="checkbox"/>
	55	5.763-021.0		30 mm pipe cleaning nozzle with internal thread. Various jet directions for environmentally-friendly cleaning of blocked drains and pipes.
Rotating pipe cleaning nozzle	56	6.415-440.0	Rotating pipe cleaning nozzle with internal thread and four rotating jets for environmentally-friendly cleaning of blocked drains and pipes.	<input type="checkbox"/>

Available accessories.

ACCESSORIES FOR HD 10/25-4 S ST CLASSIC

1.367-412.0



		Order no.	Description	
FLOOR AND HARD SURFACE CLEANER				
Hard Surface Cleaner FR 50				
Hard surface cleaner FR 50	57	2.640-679.0	Hot water resistant stainless steel surface cleaner with 500 mm working width. Ideal for large areas. With double ceramic bearings, push handle, non-marking swivel castors and detergent dosing system.	<input type="checkbox"/>
Surface Cleaner FR 50 Me	58	2.111-023.0		<input type="checkbox"/>
Machine-specific nozzle kits for FR				
Nozzle kit for FR, 850 l/h - 1100 l/h	59	2.640-442.0	Nozzle kit includes power nozzles and unions. For Kärcher surface cleaners (850 to 1100 l/h).	<input type="checkbox"/>
FOAM SYSTEMS				
Cup foam lance				
Cup foam lance Basic 3, 900 l/h - 2500 l/h	60	4.112-055.0	High-quality, simple and durable: Basic 3 cup foam lance for high-pressure cleaners with a flow rate of 900-2500 l/h. Halves the cleaning agent consumption while maintaining optimum foam quality.	<input type="checkbox"/>
Cup foam lance Advanced 3, 900 l/h - 2500 l/h	61	4.112-065.0	Specially designed for use with aggressive cleaning agents: High-quality cup foam lance Advanced 3 with spray angle adjustment and EcoBrass for high-pressure cleaners from Kärcher.	<input type="checkbox"/>
Cup foam lance DUO Advanced 3, 900 l/h - 2500 l/h	62	4.112-069.0	DUO Advanced 3 cup foam lance, designed for use with aggressive detergents. With instant switching to high-pressure cleaning, spraying angle adjustment and two-litre tank.	<input type="checkbox"/>
Inno Foam Kit				
Inno Foam Set with detergent injector	63	2.112-000.0	High-pressure foam system with double lance (foam nozzle and high-pressure jet for rinsing). For use with mobile and stationary high-pressure and HDS pressure cleaners for cleaning or disinfection.	<input type="checkbox"/>
Inno Foam Set	64	2.112-008.0		<input type="checkbox"/>
Easy Foam Set				
Easy Foam Set with RM injector	65	2.112-010.0	HP foam system for use with HD/HDS units for cleaning and disinfecting. Foam nozzle for connection to lance and HP chemical injector with precision 0-5% metering valve. The machine specific nozzle kit has to be ordered separately.	<input type="checkbox"/>
Nozzle kits for Inno/Easy Foam Set				
Nozzle kit 110 for Inno / Easy Set 1,000-1,300 l/h	66	2.111-020.0	Nozzle kit 110 contains Kärcher power nozzles and nozzle inserts. For Inn/Easy-Foam set 1000-1300 l/h. For optimal foam system performance.	<input type="checkbox"/>
Foam nozzle mounting kit				
Foam nozzle attachment kit	67	2.112-013.0	Foaming agent kit. The foam nozzle is ideal for use in sanitary areas and the food industry and wherever long application times are necessary.	<input type="checkbox"/>
MIXERS AND INJECTORS				
Cleaning agent injector				
Stainless steel injector kit for HD 10/25-4S	68	6.645-761.0	Stainless steel injector for cleaning agent and foam applications. Specifically for the HD 10/25-4 S High-pressure cleaner. For precise cleaning agent dosage.	<input type="checkbox"/>
Cleaning agent injector for high pressure (without nozzle)	69	4.637-033.0	Cleaning agent dosage at high pressure 3 - 5 %	<input type="checkbox"/>
Machine-specific nozzle kit with order no. 4.637-033.0				
Nozzle kit 1000-1200 l/h	70	4.769-013.0	For HD/HDS 1000 - 1200 l/h. Consists of nozzle insert + HP power nozzle + union	<input type="checkbox"/>

Available accessories.

ACCESSORIES FOR HD 10/25-4 S ST CLASSIC

1.367-412.0



		Order no.	Description	
QUICK CONNECT				
Quick coupling	71	2.115-000.0	For fast changes between different spray lances/accessories. Perfect for Kärcher spray unit, suitable for trigger gun/spray lance interface. With M 22 × 1.5 internal thread.	<input type="checkbox"/>
Male coupling	72	2.115-001.0	Hardened stainless steel male coupling for quick coupling 2.115-000. With M 22 × 1.5 external thread.	<input type="checkbox"/>
TAKE-OFF POINT EQUIPMENT				
Hose and spray lance holder VA	73	2.042-003.0	Hose and spray lance wall holder for practical and safe storage of high-pressure hoses or spray lances. Stainless steel wall holder.	<input type="checkbox"/>
COUPLING PARTS				
Connector				
Y distributor	74	4.111-024.0	Offers the option to connect two spray units to the machine. Installation on the high pressure outlet.	<input type="checkbox"/>
Short spray unit	75	4.111-038.0	For attaching high-pressure nozzles and accessory parts to HP trigger gun (with nozzle screws). Not compatible with triple nozzles.	<input type="checkbox"/>
EASY!Lock adapter				
Adapter 2 M22IG-TR22AG	76	4.111-030.0	Adapter 2 to connect the old device with the new hose and the old gun with the new hose	<input type="checkbox"/>
Adapter 6 TR22IG-M22AG	77	4.111-034.0	Adapter 6 to connect the new device with the old hose and the old hose with the new gun	<input type="checkbox"/>
Adapter hose extension 9 TR	78	4.111-037.0	Adapter 9 to connect the new hose with the new hose	<input type="checkbox"/>
HOSE REELS				
Automatic, self-winding hose reels for wall mounting				
Automatic hose reel, coated, 20 m	79	6.392-106.0	Automatic hose reel of durable plastic. Painted steel bracket. Suitable for 20 m high-pressure hose.	<input type="checkbox"/>
Automatic stainless steel hose reel, 40 m	80	6.392-442.0	Automatic hose reels provide the highest level of safety and convenience for winding and unwinding HP hoses. Compatible high-pressure hose, e.g. order no. 6.110-076.0 (ID 8, 40 m, 400 bar, 1x hose reel connection attachment kit).	<input type="checkbox"/>
WET BLASTING ATTACHMENT				
Wet blasting attachment (without nozzle)				
Wet blasting attachment with flow control (without nozzles)	81	4.115-000.0	Paint, rust and scale removal made easy: Kärcher wet blasting attachment with flow control for adding blasting abrasive to the high-pressure jet.	<input type="checkbox"/>
Wet blasting attachment without flow control (nozzles not included)	82	4.115-006.0	Addition of spray agent to the high pressure jet. For paint stripping, rust removal and descaling. Assembly on spray lance instead of high-pressure nozzle. Without water flow regulation	<input type="checkbox"/>
Nozzle kits for wet jet unit				
Nozzle kit for wet jet unit 050	83	2.112-023.0	Nozzle kit with wet blasting nozzle and nozzle insert (type specific). For optimal Kärcher wet blasting attachment performance. Only in combination with wet blasting attachment .	<input type="checkbox"/>
Boron carbide nozzle				
Boron carbide, for machines from 1,000 l/h	84	6.415-083.0	In addition to nozzle packs. Very wear-resistant nozzle with boron carbide chuck for continuous-duty operation.	<input type="checkbox"/>

Available accessories.

ACCESSORIES FOR HD 10/25-4 S ST CLASSIC 1.367-412.0

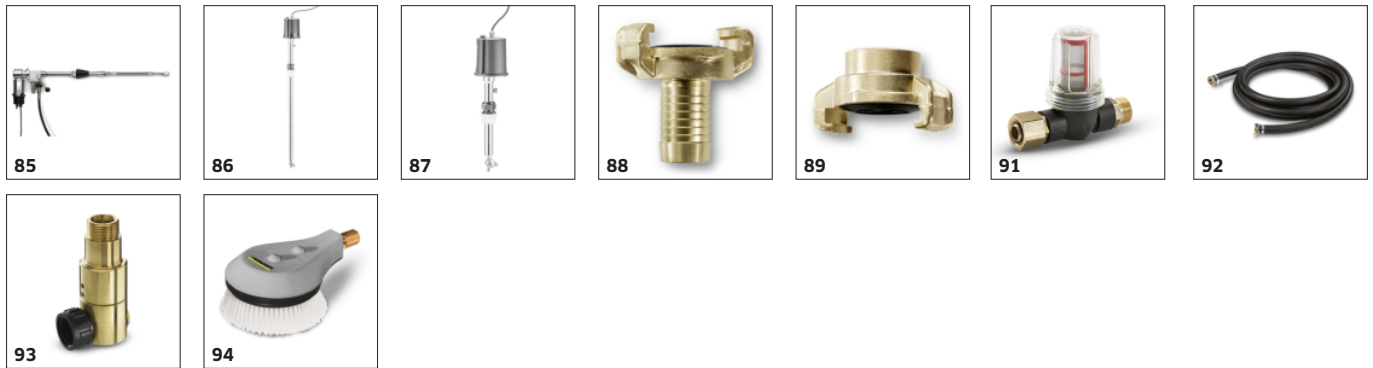

	Order no.	Description	
DRUM AND TANK CLEANING			
Barrel and tank cleaning			
Barrel cleaner BC 14/12	85	2.112-020.0	The BC 14/12 barrel cleaner is a spray unit for the interior cleaning of containers and barrels - especially oak barrels with a capacity of between 225 and 600 litres. <input type="checkbox"/>
HKF 50 M spray head	86	3.631-039.0	Constant rotational speed and lightweight design: The compact interior cleaning head for cleaning vats and tanks with openings of 50 mm or wider. <input type="checkbox"/>
	87	3.631-058.0	Compact interior cleaning head for cleaning containers with openings of 50 millimetres or wider. The device stands out from the crowd with its constant rotational speed and lightweight design. <input type="checkbox"/>
WATER CONNECTION			
Geka coupling			
Geka connector with hose barb, R 1"	88	6.388-465.0	with hose barb <input type="checkbox"/>
Geka connector with internal thread, R 1"	89	6.388-458.0	with female thread <input type="checkbox"/>
Water fine filter			
Universal water fine filter, 25 µm	90	2.637-020.0	Water fine filter, mesh size 25 µm, max. temperature 50 °C. Protects the machine from small dirt particles in the water. Water volume up to 1200 l/h. 3/4" connection, with 1" adapter. <input type="checkbox"/>
Water fine filter, 100 µm, R 1"	91	2.638-270.0	Fine-mesh water filter, 100 µm, max. temperature 60°C. Connects to high-pressure cleaner. Protects the high-pressure cleaner from dirt particles contained in the water. Water flow rate up to 1200 l/h. Connector 1". <input type="checkbox"/>
Water supply hose			
Water supply hose	92	4.440-270.0	NW 19 R1" / R1", up to 85 °C <input type="checkbox"/>
Backflow check valve			
Backflow preventer	93	2.641-374.0	To prevent detergent getting into the drinking water cycle in case of inlet at low-pressure. - hot water resistant up to 80 °C - tested according to IEC 60335-2-79 - integrated leakage protection <input type="checkbox"/>
WASHING BRUSHES			
Rotating washing brush			
Rotating wash brush for > 800 l/h machines, nylon bristles	94	4.113-002.0	Driven by water stream. Gently removes fine dust and traffic film from any surface. Temperature resistant up to 60°C, M 18 × 1.5 (replaceable brush insert). <input type="checkbox"/>
HIGH PRESSURE			
	95		<input type="checkbox"/>

Available accessories.